

---

# Horizon Big

Scheda di montaggio  
Assembly instructions

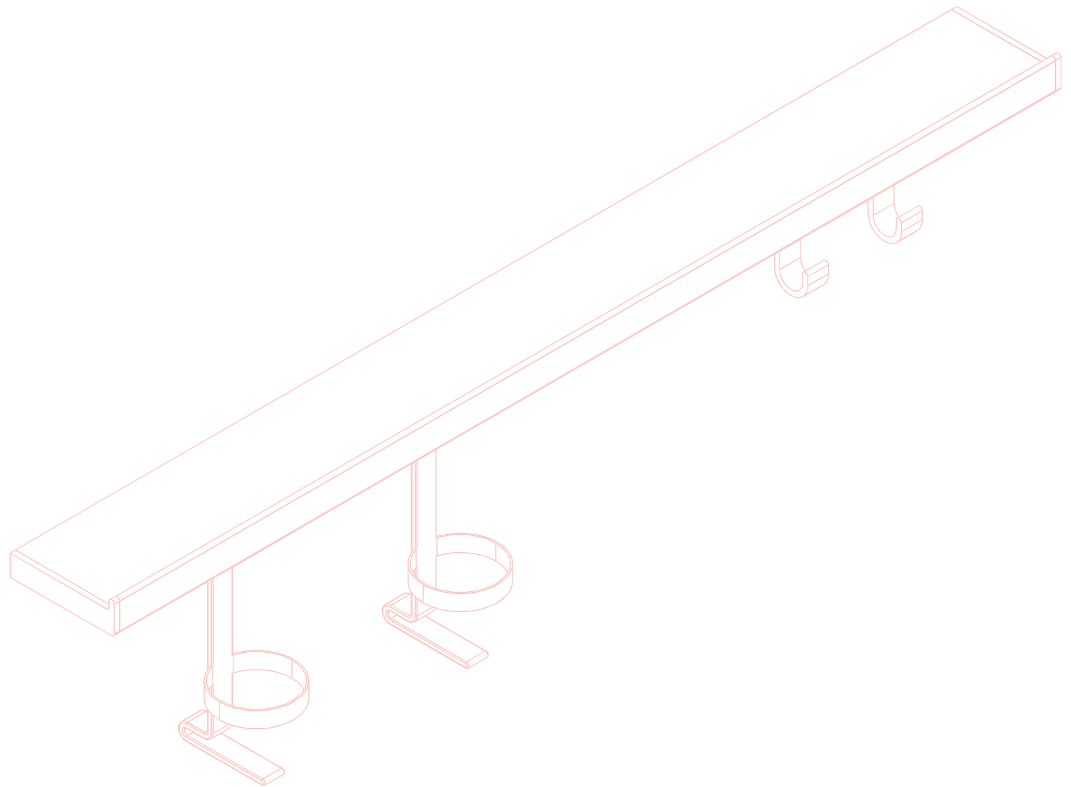

[www.damianolatini.it](http://www.damianolatini.it)



**Damiano Latini S.r.l.**  
Via Sandro Pertini, 63812  
Montegranaro (FM) Italy  
T +39 0734 894144 F + 39 0734 894152  
[Info@damianolatini.it](mailto:Info@damianolatini.it) - [www.damianolatini.it](http://www.damianolatini.it)

---

# Horizon Big

## Materiale | Materials

**A**  Vite da muro + tassello  
Self-tapping screws + wall plug  
N.4 pcs (4 x 35 mm)

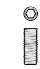
**B**  Grani a testa esagonale  
Hexagonal head grains  
N.2 pcs (4 x 12 mm)

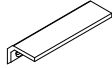
 Attaccaglia per muro  
Wall holder profile  
N.2 pcs (14 x 10 mm)

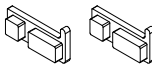
 Elementi di chiusura  
Closing element  
N.2 pcs

 Profilo in alluminio  
Aluminium profile  
N.1 pcs

## Strumenti necessari | Required tools

Trapano | Drill



Cacciavite a croce |  
Phillips Screwdriver



Punta trapano | Drill bit



Chiave a brugola |  
Allen key

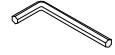

This is in the box!

### 1 Prendere le misure | Mark measures

Segnare a muro dove forare.

Mark on the wall where to drill.

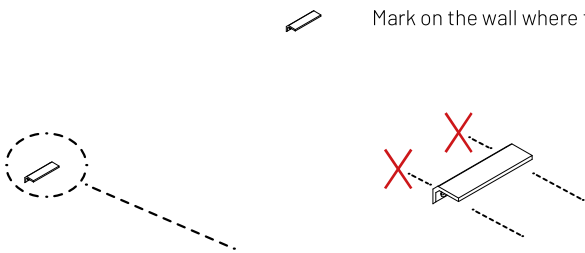

### 2 Forare il muro | Drill the wall

Forare ed inserire il supporto.

Drill and insert wall plug.

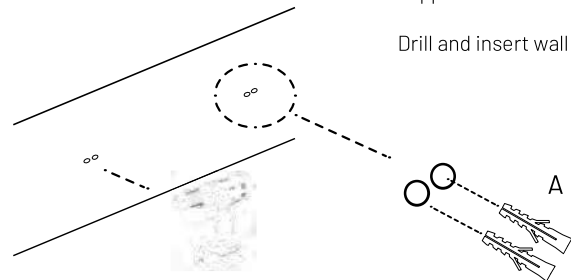

### 3 Avvitare l'attaccaglia | Screw holder profile

Infilare **TUTTE** le viti e distanziali nel Back, per poi spingerlo a muro.

Predisporre **ALL** screws and wall spacers on Back, then fit on wall.

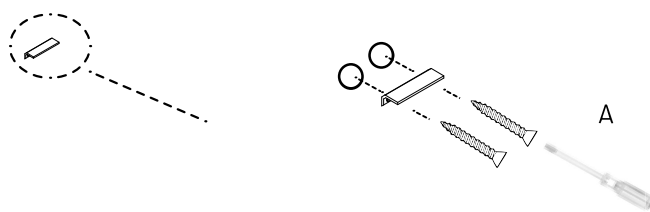

### 4 Avvitare il tutto | Screw the whole

Fissare il profilo con i grani.

Fix the aluminium profile with grains.

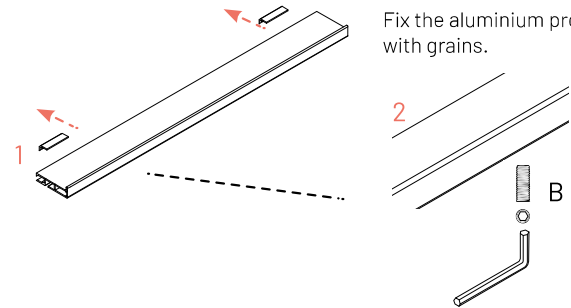

### 5 Montare i tappi | Fit closing element

Incastrare gli elementi di chiusura alle estremità.

Fit closing elements to edges.

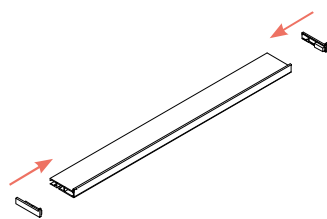

www.damianolatini.it



Damiano Latini S.r.l.  
Via Sandro Pertini, 63812  
Montegranaro (FM) Italy  
T +39 0734 894144 F +39 0734 894152  
Info@damianolatini.it - www.damianolatini.it